

SITE INFORMATION:

PARCEL ID: R0500-003-184-000
 CURRENT ZONING: O&M (CO)
 PROPOSED USE: OFFICE (MEDICAL/PROFESSIONAL)
 PROJECT SITE AREA: 114.60 ACRES
 ZONING SITE AREA: 2202.27 AC
 OWNER INFORMATION: CAMERON PROPERTIES LAND CO
 PO BOX 3649
 WILMINGTON, NC 28406

FLOOD INFORMATION:
 THIS PARCEL IS LOCATED IN FLOOD ZONE X, WHICH IS NOT A SPECIAL FLOOD HAZARD AREA AS DETERMINED BY FEMA FLOOD PANEL #17031-2200A DATED APRIL 3, 2009
 URBAN
 CPPLA EASEMENT MB 60 PG 231

CAMA LAND USE CLASSIFICATION BASEMENTS:
 URBAN
 CPPLA EASEMENT MB 60 PG 231

NOTE - PROJECT SUBJECT TO CONDITIONS OF CONDITIONAL DISTRICT (CD-7-213) AND MOU (DATED 6/19/15)

REGULATED TREES TO BE REMOVED:

X = REGULATED TREE TO BE REMOVED

12" PINE = 49	4" MAGNOLIA = 1
14" PINE = 36	5" MAGNOLIA = 1
16" PINE = 16	8" OAK = 1
18" PINE = 7	9" BAY = 1
19" PINE = 6	10" OAK = 1
17" PINE = 1	

NC DENR PWSS WATER PERMIT #:	
WATER CAPACITY:	GPD
DWQ SEWER PERMIT #:	
SEWER CAPACITY:	GPD
SEWER SHED # AND PLANT:	
SEWER TO FLOW THROUGH NEI:	YES OR NO (CIRCLE ONE)

For each open utility cut of City streets, a \$325 permit shall be required from the City prior to occupancy and/or project acceptance.

NOTES:

- REFER TO SHEET C-2.0 SITE PLAN FOR PROPOSED PHASING AND PROPOSED DEVELOPMENT.
- NO SIGNIFICANT TREES LOCATED ON SITE. NO SIGNIFICANT TREES PROPOSED FOR REMOVAL.
- ALL REGULATED TREES TO BE REMOVED ARE PART OF NECESSARY SITE IMPROVEMENTS AND THEREFORE ARE NOT REQUIRED TO BE MITIGATED. SITE GRADING AND CONSTRUCTION REQUIRE REMOVAL OF ALL VEGETATION FOR ESSENTIAL SITE IMPROVEMENTS, EXCEPT AS SHOWN.
- A TREE REMOVAL PERMIT IS REQUIRED PRIOR TO CLEARING AND GRADING CAN OCCUR.
- PRIOR TO ANY CLEARING, GRADING, OR CONSTRUCTION ACTIVITY, TREE PROTECTION FENCING WILL BE INSTALLED AROUND PROTECTED TREES OR GROVES OF TREES & REVIEWED BY CITY STAFF. NO CONSTRUCTION WORKERS, TOOLS, MATERIALS OR VEHICLES ARE PERMITTED WITHIN TREE PROTECTION FENCING.

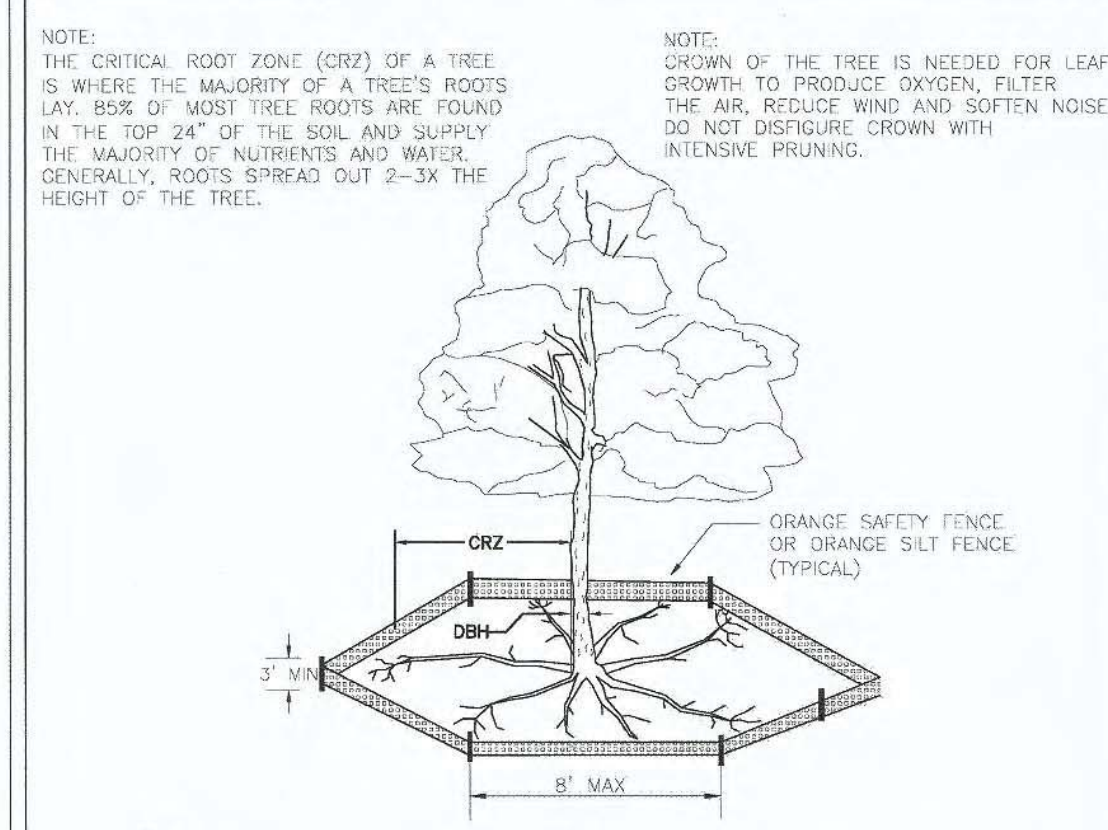

- PROTECT CRITICAL ROOT ZONE (CRZ) OF TREES PRIOR TO CONSTRUCTION. CLEARLY MARK THE TREES AND ERECT A PROTECTIVE BARRIER AT THE CRZ. BARRIER SHALL BE MAINTAINED UNTIL CONSTRUCTION IS COMPLETE.
- CRZ RADIUS IS 1 FT PER INCH OF TREE DIAMETER AT BREAST HEIGHT (DBH).
- IF CONSTRUCTION OCCURS WITHIN THE CRZ, AT LEAST 12" OF MULCH AND/OR LOGGING MATS SHALL BE PLACED WHERE MACHINERY MANEUVERS TO REDUCE SOIL COMPACTION IN THIS ZONE.
- WHERE SIDEWALKS AND PATHWAYS PASS WITHIN CRZ, EXTRA CARE SHALL BE TAKEN TO AVOID DAMAGE TO THE ROOTS. ALTERNATE CONSTRUCTION METHODS, SUCH AS A REINFORCED SIDEWALK, SHALL BE IMPLEMENTED AS NECESSARY.
- FOR ALL TREES, CUTTING OF LARGE STRUCTURAL ROOTS LOCATED NEAR THE BASE OF THE TRUNK IS PROHIBITED. DO NOT COMPACT SOIL BENEATH TREES. NO VEHICLE SHALL BE ALLOWED TO PARK UNDER TREES. NO MATERIALS OR EQUIPMENT SHALL BE STORED BENEATH TREES, DAMAGING THE BARK WITH SAWMILLS, CONSTRUCTION EQUIPMENT, OR ANYTHING ELSE IS PROHIBITED.
- CONTRACTOR SHALL REPAIR DAMAGE TO TREES.
- FALLING TO INSTALL OR MAINTAIN PROTECTION MEASURES SHALL RESULT IN A STOP WORK ORDER AND FINE OF \$500/DAY, DISTURBANCE OTHER THAN THAT ALLOWED ON THE APPROVED PLAN WILL REQUIRE OWNER TO POST A LETTER OF CREDIT FOR 3 YRS FOR TREE MITIGATION.

STANDARD DETAIL
TREE PROTECTION DURING CONSTRUCTION
 SHEET 1 of 2

DATE: JAN, 2015
 DRAWN BY: JSE
 CHECKED BY: RKL, P.E.
 SCALE: NOT TO SCALE

CITY OF WILMINGTON
 NORTH CAROLINA
 CITY OF WILMINGTON ENGINEERING
 PO BOX 1810
 WILMINGTON, NC 28402
 (910) 341-7807

SD 15-09

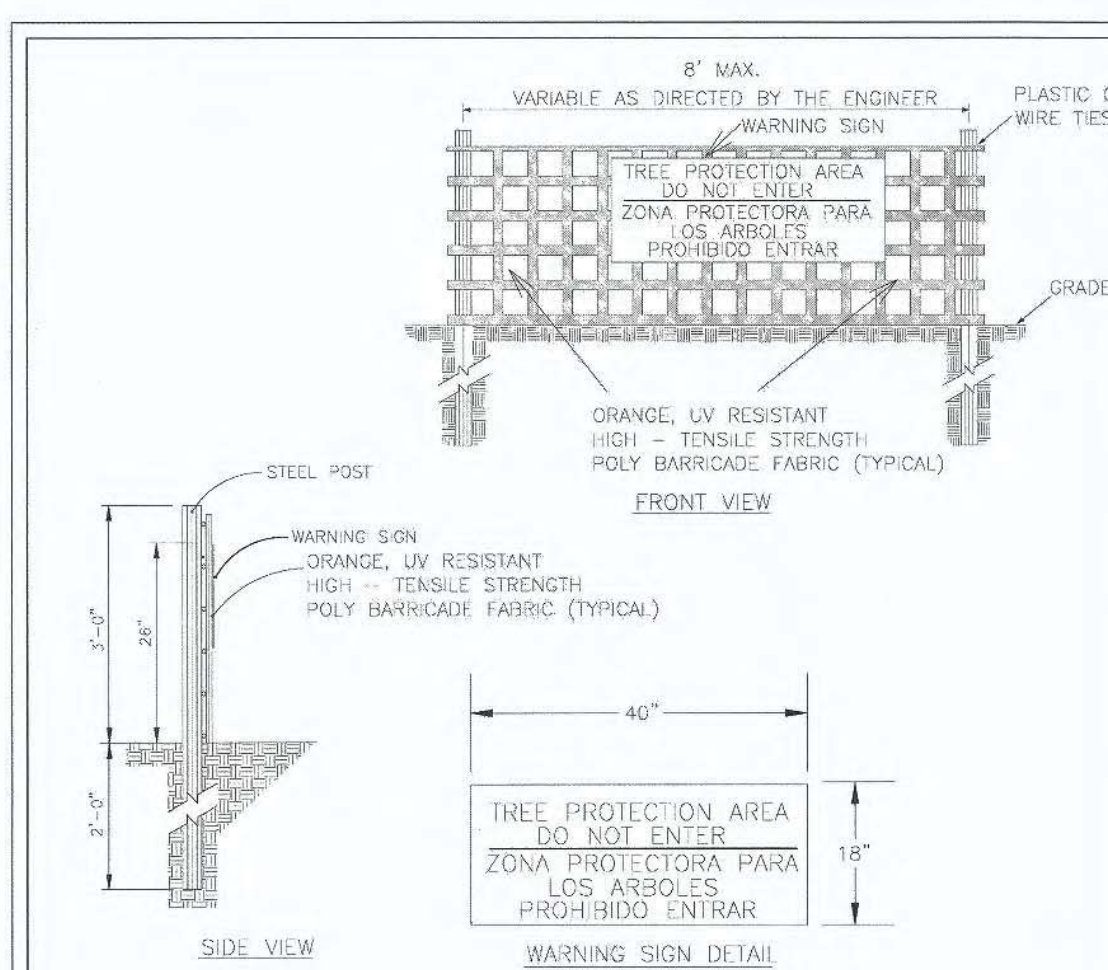

STANDARD DETAIL
TREE PROTECTION DURING CONSTRUCTION
 SHEET 2 of 2

DATE: JAN, 2015
 DRAWN BY: JSE
 CHECKED BY: RKL, P.E.
 SCALE: NOT TO SCALE

CITY OF WILMINGTON
 NORTH CAROLINA
 CITY OF WILMINGTON ENGINEERING
 PO BOX 1810
 WILMINGTON, NC 28402
 (910) 341-7807

SD 15-09

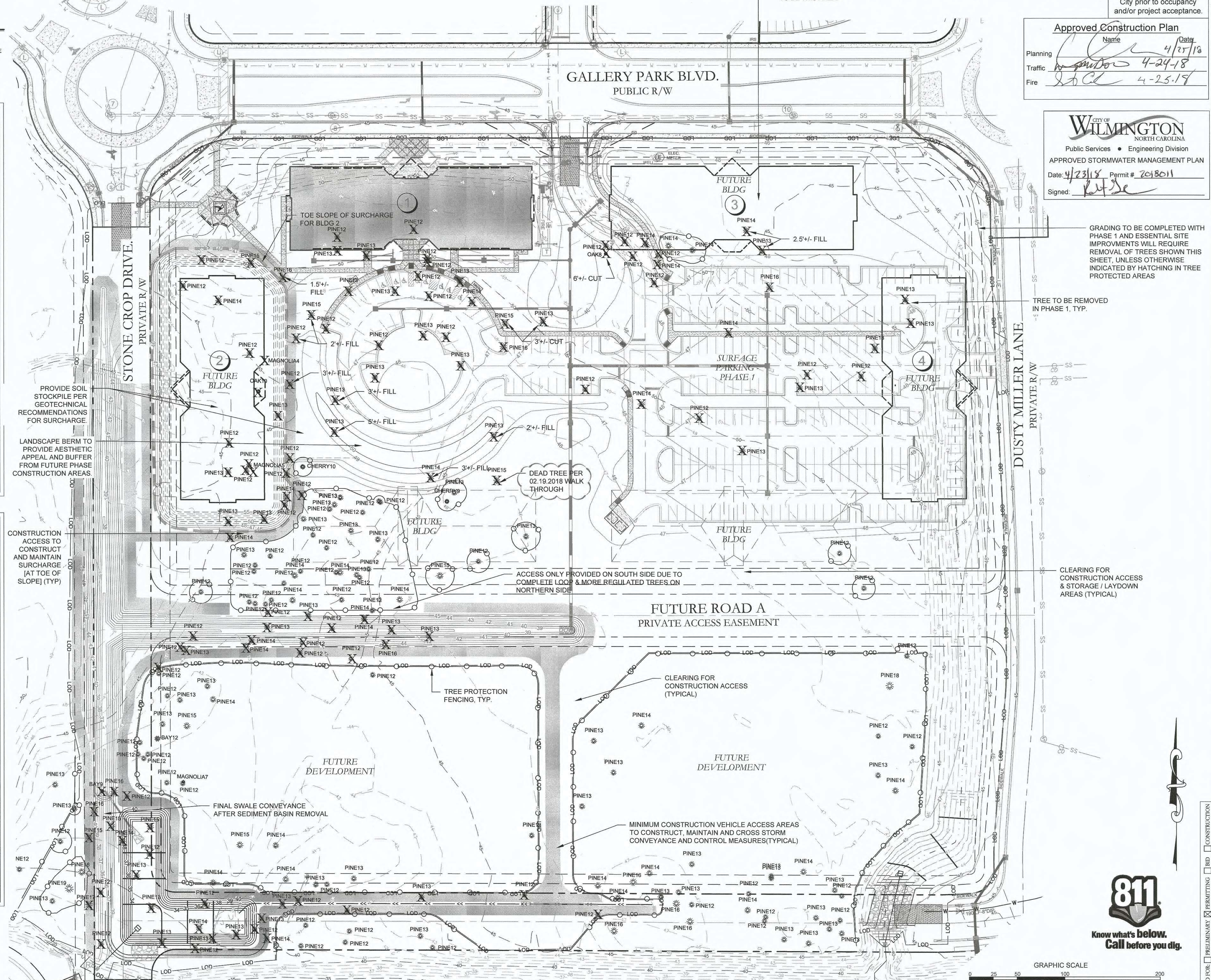

Approved Construction Plan

Name: _____ Date: 4/23/18

Planning: _____ Date: 4-24-18

Traffic: _____

Fire: _____ Date: 4-25-18

CITY OF WILMINGTON
 NORTH CAROLINA
 Public Services • Engineering Division
 APPROVED STORMWATER MANAGEMENT PLAN
 Date: 4/23/18 Permit # 2018011
 Signed: RKL

GRADING TO BE COMPLETED WITH PHASE 1 AND ESSENTIAL SITE IMPROVEMENTS WILL REQUIRE REMOVAL OF TREES SHOWN THIS SHEET, UNLESS OTHERWISE INDICATED BY HATCHING IN TREE PROTECTED AREAS

TREE TO BE REMOVED IN PHASE 1, TYP.

CLEARING FOR CONSTRUCTION ACCESS & STORAGE/LAYDOWN AREAS (TYPICAL)

ACCESS ONLY PROVIDED ON SOUTH SIDE DUE TO COMPLETE LOOP & MORE REGULATED TREES ON NORTHERN SIDE

MINIMUM CONSTRUCTION VEHICLE ACCESS AREAS TO CONSTRUCT, MAINTAIN AND CROSS STORM CONVEYANCE AND CONTROL MEASURES (TYPICAL)

FINAL SWALE CONVEYANCE AFTER SEDIMENT BASIN REMOVAL

TREE PROTECTION FENCING, TYP.

CONSTRUCTION STAGING AREA AND MATERIAL STORAGE. ENTIRE PAD WILL BE GRADED & PREPPED WITH SURFACE PARKING. CONSTRUCTION TRAILER LOCATION ANTICIPATED TO BE THIS AREA.

GRADING TO BE COMPLETED WITH PHASE 1 AND ESSENTIAL SITE IMPROVEMENTS WILL REQUIRE REMOVAL OF TREES SHOWN THIS SHEET, UNLESS OTHERWISE INDICATED BY HATCHING IN TREE PROTECTED AREAS

TREE TO BE REMOVED IN PHASE 1, TYP.

CLEARING FOR CONSTRUCTION ACCESS & STORAGE/LAYDOWN AREAS (TYPICAL)

ACCESS ONLY PROVIDED ON SOUTH SIDE DUE TO COMPLETE LOOP & MORE REGULATED TREES ON NORTHERN SIDE

MINIMUM CONSTRUCTION VEHICLE ACCESS AREAS TO CONSTRUCT, MAINTAIN AND CROSS STORM CONVEYANCE AND CONTROL MEASURES (TYPICAL)

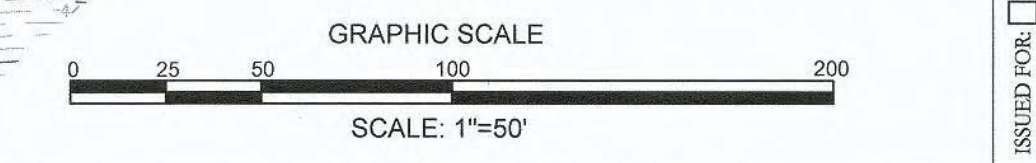

REVISIONS:
 1. PER 02.19.2018 CITY WALK THROUGH

CLIENT INFORMATION:
Cameron Properties Land Co
 PO BOX 3649
 Wilmington, NC 28406

PARAMOUNT ENGINEERING
 122 Cinema Drive
 Wilmington, North Carolina 28403
 (910) 791-6707 (O) (910) 791-6760 (F)
 NC License #: C-2846

TREE REMOVAL PLAN
 THE POINTE AT BARCLAY
 THREE-LEVEL OFFICE BUILDING
 CITY OF WILMINGTON
 NORTH CAROLINA

PROJECT STATUS:
 PRELIMINARY LAYOUT: _____
 FINAL DESIGN: _____
 RELEASED FOR CONSTRUCTION: _____

DRAWING INFORMATION:
 DATE: 02.02.18
 SCALE: 1"=50'
 DRAWN: JRC
 CHECKED: DJF

ISSUED FOR: _____
 PRELIMINARY: _____
 PERMITTING: _____
 CONSTRUCTION: _____

811
 Know what's below.
 Call before you dig.

C-1.1
 PEI JOB#: 17286.PE