

Site Information
 Project Owner: Corning Credit Union, Randy Hamilton, 607-936-3144
 1 Credit Union Plaza, Corning, NY 14830

Proposed Buildings (both parcels) Footprint: 12,852 SF
 Proposed Parking Lots (both parcels): 66,085 SF

Note: Prior to any clearing, grading, or construction activity, tree protection fencing will be installed around protected trees or groves of trees.
 No construction workers, tools, materials, or vehicles are permitted within the tree protection fencing.

Note: All proposed vegetation within sight triangles shall not interfere with clear visual sight lines from 30' to 10', per city sec 18-556 CotW LDC.

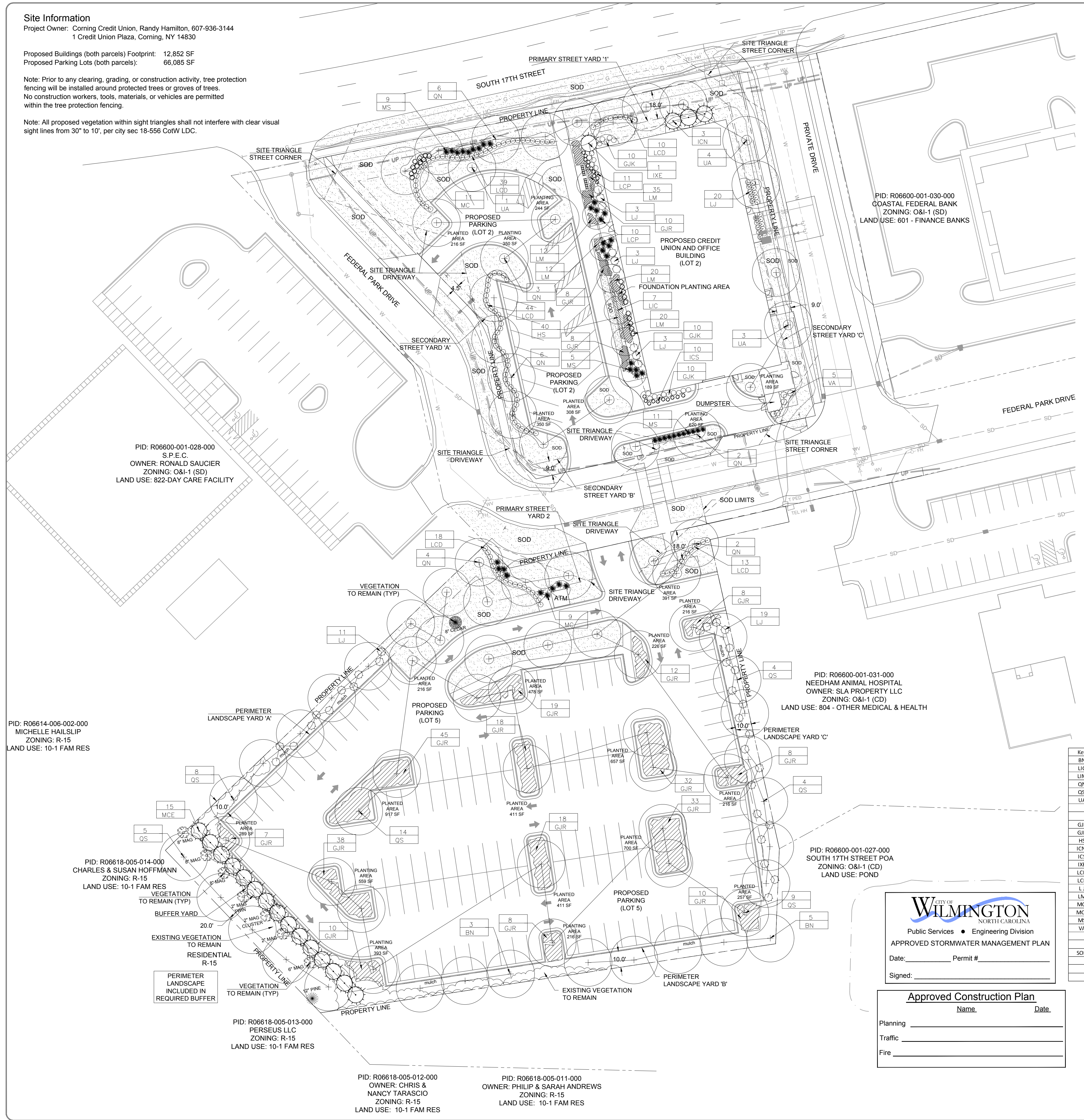

STREET YARD LANDSCAPE - O&I-1 ZONING DISTRICT

BUILDING PARCEL (LOT 2)
 PRIMARY STREET YARD '1'
 18' WIDE x 259.99' LENGTH = 4,680 S.F. TOTAL
 144 S.F. IMPERVIOUS (3.1%) - WALKWAYS, WALLS (NO PARKING)
 4,680 S.F. / 600 S.F. = 7.8 TREES REQUIRED, 8 TREES PROPOSED
 7.8 x 6 = 46.8 SHRUBS REQUIRED, 47 SHRUBS PROPOSED
 SECONDARY STREET YARD 'A'
 4.5' WIDE (50% REQUIRED) x 226.67' LENGTH = 1,020 S.F. TOTAL
 0 S.F. IMPERVIOUS (0%) - WALKWAYS, WALLS (NO PARKING)
 1,020 S.F. / 600 S.F. = 1.7 TREES REQUIRED, 2 TREES PROPOSED
 1.7 x 6 = 10.2 SHRUBS REQUIRED, 10 SHRUBS PROPOSED
 SECONDARY STREET YARD 'B'
 9' WIDE (50% REQUIRED) x 119.36' LENGTH = 1,074 S.F. TOTAL
 72 S.F. IMPERVIOUS (7%) - WALKWAYS, WALLS (NO PARKING)
 1,074 S.F. / 600 S.F. = 1.8 TREES REQUIRED, 2 TREES PROPOSED
 1.8 x 6 = 10.8 SHRUBS REQUIRED, 11 SHRUBS PROPOSED
 SECONDARY STREET YARD 'C'
 9' WIDE (50% REQUIRED) x 218.21' LENGTH = 1,964 S.F. TOTAL
 220 S.F. IMPERVIOUS (11%) - WALKWAYS, WALLS (NO PARKING)
 1,964 S.F. / 600 S.F. = 3.3 TREES REQUIRED, 3 TREES PROPOSED
 3.3 x 6 = 19.8 SHRUBS REQUIRED, 20 SHRUBS PROPOSED

PARKING PARCEL (LOT 5)
 PRIMARY STREET YARD '2'
 18' WIDE x 119.17' LENGTH = 2,145 S.F. TOTAL
 90 S.F. IMPERVIOUS (4%) - WALKWAYS, WALLS (NO PARKING)
 2,145 S.F. / 600 S.F. = 3.6 TREES REQUIRED, 4 TREES PROPOSED
 3.6 x 6 = 21.6 SHRUBS REQUIRED, 22 SHRUBS PROPOSED

TREES PER DISTURBED AREA
 2.78 ACRES x 15 = 41.7 TREES REQUIRED
 49 TREES PROVIDED

PARKING LOT LANDSCAPE

INTERIOR AREA (BOTH PARCELS)
 66,085 S.F. TOTAL IMPERVIOUS SURFACE x 20% = 13,217 S.F.
 13,217 S.F. / 707 S.F. = 18.7 CANOPY TREES REQUIRED
 19 CANOPY TREES PROVIDED

PERIMETER LANDSCAPE 'A'
 10' WIDE x 274.00' LENGTH
 274.00' / 27' = 10.1 TREES REQUIRED, 10 TREES PROPOSED
PERIMETER LANDSCAPE 'B'
 10' WIDE x 284.35' LENGTH
 284.35' / 27' = 10.5 TREES REQUIRED, 11 TREES PROPOSED
PERIMETER LANDSCAPE 'C'
 10' WIDE x 254.20' LENGTH
 254.20' / 27' = 9.4 TREES REQUIRED, 9 TREES PROPOSED

PARKING AREA SCREEN

SHRUB BUFFER AT PARKING AREAS ADJACENT TO R.O.W.
 MINIMUM 3' HT., 5' O.C.

FOUNDATION PLANTINGS (including ATM)

257.44 L.F. x 45' MAXIMUM BUILDING HEIGHT = 11,585 S.F.
 11,585 S.F. x 12% = 1,390 S.F. LANDSCAPE AREA REQUIRED, 1,600 S.F. AREA PROPOSED

DUMPSTER SCREEN

8' HT. SHRUB BUFFER AT DUMPSTER ADJACENT TO R.O.W.

BUFFER YARD

20' WIDE x 138.67 L.F.
 1 TREE / 30 LENGTH = 4.6 TREE REQUIRED, 15 UNDERSTORY PROPOSED
 NATURAL VEGETATION TO REMAIN

REGULATED EXISTING TREES - TO BE MITIGATED

SEE DEMOLITION SHEET FOR LOCATIONS

EXISTING TREES TO REMAIN

8" DBH CEDAR	2 CREDITS
2" DBH MAGNOLIA (3)	3 CREDITS
6" DBH MAGNOLIA	2 CREDITS
8" DBH MAGNOLIA (3)	6 CREDITS
12" DBH PINE	3 CREDITS
TOTAL	16 CREDITS

EXISTING TREES TO BE REMOVED

6" DBH MAGNOLIA	
8" DBH OAK	
12" DBH PINE (2)	
14" DBH PINE	
16" DBH PINE	
20" DBH PINE	
88" DBH TOTAL (100% MITIGATION) / 3	= 29 REPLACEMENT TREES REQUIRED

29 REPLACEMENT - 16 CREDIT = 13 REPLACEMENT TREES REQUIRED
 13 REPLACEMENT TREES PROVIDED

TREES

Qty	Botanical Name	Common Name	Size & Spacing	
8	BETULA NIGRA 'HERITAGE'	RIVER BIRCH	8-10 FT. MULTI-STEM	understory
7	LAGERSTROEMIA INDICA 'CATAWBA'	CATAWBA CRAPE MYRTLE	8-10 FT. MULTI-STEM	understory
3	LAGERSTROEMIA INDICA X FAURIEI 'MUSKOGEE'	MUSKOGEE CRAPE MYRTLE	8-10 FT. MULTI-STEM	understory
24	QUERCUS NUTTALLI	NUTTALL OAK	2.5 INCH CALIPER	canopy
37	QUERCUS SHUMARDII	SHUMARD OAK	2.5 INCH CALIPER	canopy
13	ULMUS AMERICANA 'PRINCETON'	PRINCETON ELM	2.5 INCH CALIPER	canopy

SHRUBS/GROUNDCOVERS

30	GARDENIA JASMINOIDES 'KLEIM'S HARDY'	KLEIM'S HARDY GARDENIA	18 INCH HGT. EQ. SPACING	
274	GARDENIA JASMINOIDES 'RADICANS'	GARDENIA RADICANS	12 INCH HGT. EQ. SPACING	
40	HEMEROCALLIS 'STELLA DE ORO'	STELLA DE ORO DAYLILY	12 INCH HGT. EQ. SPACING	
3	ILEX CORNUTA 'NEEDLEPOINT'	NEEDLEPOINT HOLLY	30 INCH HGT. EQ. SPACING	
1	ILEX CRENATA 'SOFT TOUCH'	SOFT TOUCH HOLLY	18 INCH HGT. @ 3 FT. OC	
1	ILEX 'EMILY BRUNNER'	EMILY BRUNNER HOLLY	8-10 FT. FULL TO GROUND	
143	LOROPETALUM CHINENSE 'DARUMA'	DARUMA LOROPETALUM	36 INCH HGT. @ 4 FT. OC	
21	LOROPETALUM CHINENSE 'PURPLE DIAMOND'	PURPLE DIAMOND LOROPETALUM	20 INCH HGT. @ 4 FT. OC	
59	LIGUSTRUM JAPONICUM 'EAST BAY'	EAST BAY LIGUSTRUM	18 INCH HGT. @ 4 FT. OC	
99	LIRIOPE MUSCARI 'EVERGREEN GIANT'	EVERGREEN GIANT LIRIOPE	12 INCH HGT. EQ. SPACING	
20	MUHLENBERGIA CAPILLARIS	PINK MUHLY GRASS	12 INCH HGT. EQ. SPACING	
15	MYRICA CERIFERA	SOUTHERN WAX MYRTLE	48 INCH HGT. @ 15 FT. OC	
15	MISCANTHUS SINENSIS 'ADAGIO'	ADAGIO GRASS	12 INCH HGT. EQ. SPACING	
5	VIBURNUM AWABUKI 'CHINDO'	CHINDO VIBURNUM	30 INCH HGT. EQ. SPACING	

GRASS/SOD

SOD	25,050(sf)	CYNODON DACTYLON	BERMUDA	SOD
see plan		MULCH	PINE STRAW LONG NEEDLES	BALE

CITY OF WILMINGTON
 NORTH CAROLINA
 Public Services • Engineering Division
 APPROVED STORMWATER MANAGEMENT PLAN
 Date: _____ Permit # _____
 Signed: _____

Approved Construction Plan

Name	Date
Planning	_____
Traffic	_____
Fire	_____

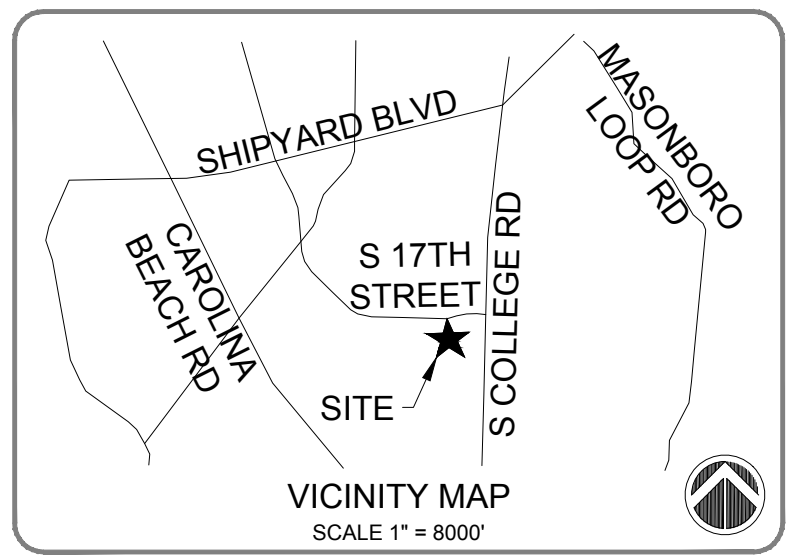
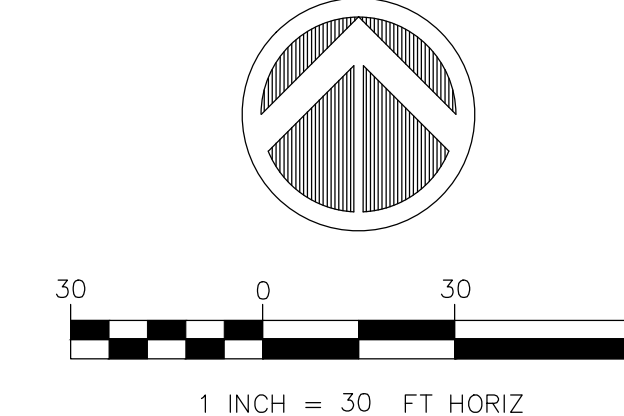

LEGEND:
 SEE SHEET I-1 FOR GENERAL NOTES AND LEGEND

REV. #	DESCRIPTION	REV. BY	DATE
	REVISIONS		



NOT FOR CONSTRUCTION

CAPE FEAR ENGINEERING
 151 Poole Rd., Suite 100, Belville, NC, 28451
 TEL (910) 383-1044; FAX (910) 383-1045
 www.capefearengineering.com
 N.C. LICENSE # C-1621

PROJECT NUMBER:	275-70
SCALE:	1" = 30'-0"
DATE:	11 APR 18
	31 MAY 16

SOUTH 17TH STREET CORNING CREDIT UNION

PLANTING PLAN

PROJECT NUMBER	275-70	SHEET NUMBER	L-1
----------------	--------	--------------	-----