



Planning, Development and Transportation

Transportation Planning
305 Chestnut Street
PO Box 1810
Wilmington, NC 28402-1810

DATE: 04.14.2020
TO: ProTrak
FROM: Mitesh Baxi
Traffic Engineering

910 341-3258
910 341-7801 fax
www.wilmingtonnc.gov
Dial 711 TTY/Voice

ANSLEY PARK [TRC Plan Review #7]

TECHNICAL STANDARDS:

Sheet C-2.8 shows proposed ADA ramp at the southern corner of Fairview Dr and Orchid Dr. Please ensure that the stop bar and stop sign are relocated in advance of the crosswalk or shift the ramp to align it to the existing ramp on the receiving side (north side of Orchid Dr) and in front of the existing stop bar. Although this intersection may have been missed during the previous review, the changes will be required during the installations as per City/ADA standards.

A separate revision will not be required for above comment and can be revised with the final submittal.

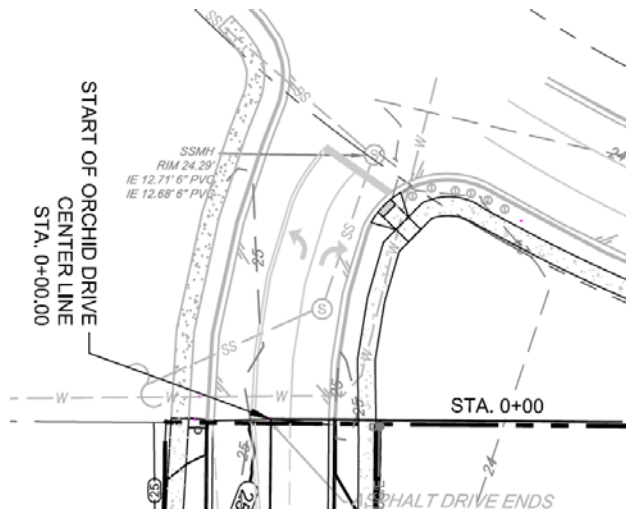

Please let me know if you have any questions.