

Engineering has reviewed the plans for the Renaissance Market project submitted October 25, 2018 and have the following comments.

1. Proposed landscaping is either on top of or in very close proximity to storm drain piping. Landscaping needs to be shifted. Please see attached Landscape Plan for redlines.

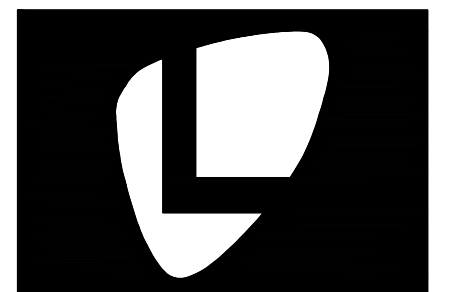

LIGGETT DESIGN GROUP

LANDSCAPE ARCHITECTURE
SITE PLANNING & DESIGN

725-A PERRYING ROAD, RALEIGH, NC 27608
PHONE: 919.853.0303 FAX: 919.853.1116
MAIL: LIGGETTDESIGNGROUP.COM

ENGINEER:
NORRIS & TUNSTALL
802 MARKET ST., WILMINGTON, NC
910.343.9053

DEVELOPER:
FRANCIS G. TRASK, III, PRESIDENT
TRASK LAND COMPANY, INC.
1202 EASTWOOD RD.
WILMINGTON, NC 28403
910.799.8785

SEALS/SIGNATURE

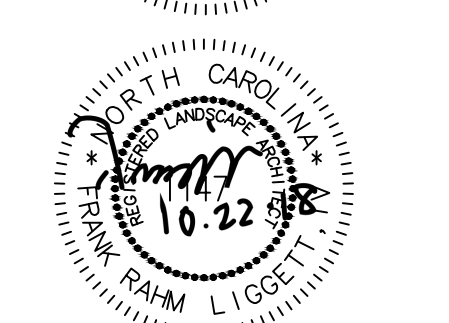
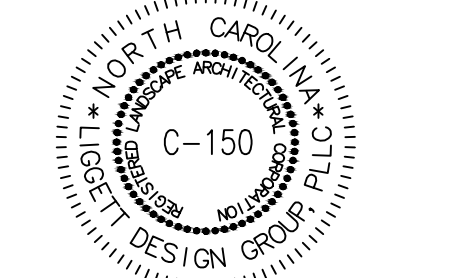

NOT APPROVED FOR
CONSTRUCTION UNLESS SIGNED
BY LANDSCAPE ARCHITECT

CLIENT

RENAISSANCE NORTH MARKET
MILITARY CUTOFF ROAD
WILMINGTON, NORTH CAROLINA

ISSUED FOR:
SUBMITTAL

ISSUED DATE:
11/3/2017

REVISIONS:

NO.	ITEM	DATE
1	ROUND 1 CITY COMMENTS	1/12/18
2	ROUND 2 CITY COMMENTS	2/22/18
3	ROUND 3 CITY COMMENTS	3/14/18
4	ROUND 4 CITY COMMENTS	8/13/18
5	ROUND 5 CITY COMMENTS	10/18/18

DRAWING TITLE:

LANDSCAPE CALCULATIONS PLAN

DRAWN BY: RW/WAB

CHECKED BY: FL

SCALE: 1"=40'

SHEET NUMBER:

L-1
OF 3

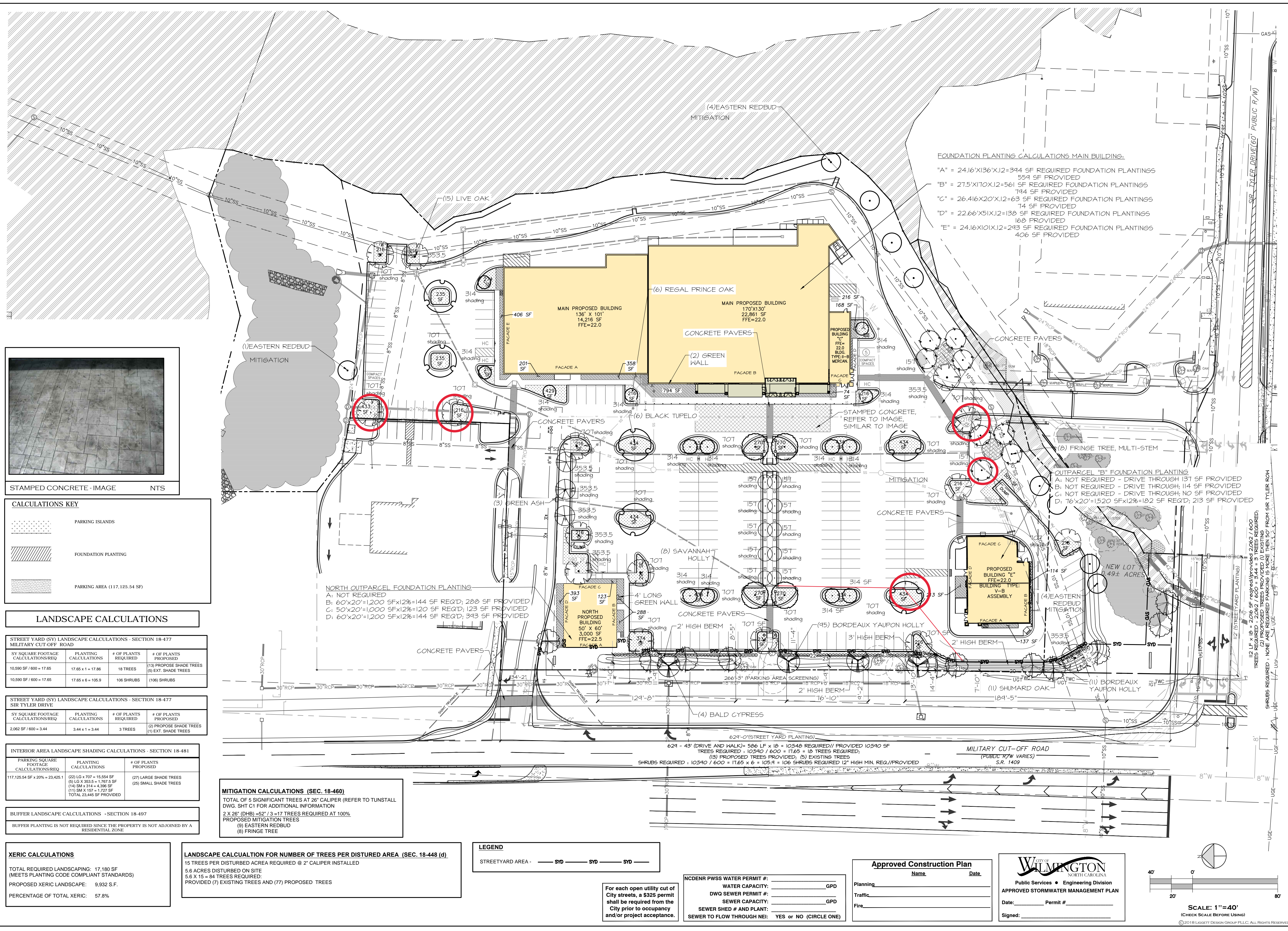

FOUNDATION PLANTING CALCULATIONS MAIN BUILDING:

"A" = 24.16'x136'x12=344 SF REQUIRED FOUNDATION PLANTINGS
554 SF PROVIDED

"B" = 27.5'x170'x12=561 SF REQUIRED FOUNDATION PLANTINGS
744 SF PROVIDED

"C" = 26.416'x20'x12=63 SF REQUIRED FOUNDATION PLANTINGS
74 SF PROVIDED

"D" = 22.66'x51'x12=138 SF REQUIRED FOUNDATION PLANTINGS
168 SF PROVIDED

"E" = 24.16'x101'x12=243 SF REQUIRED FOUNDATION PLANTINGS
406 SF PROVIDED

OUTPARCEL "B" FOUNDATION PLANTING

A: NOT REQUIRED - DRIVE THROUGH; 131 SF PROVIDED
B: NOT REQUIRED - DRIVE THROUGH; 114 SF PROVIDED
C: NOT REQUIRED - DRIVE THROUGH; NO SF PROVIDED
D: 16'x20'=1520 SFx12%=182 SF REQ'D; 213 SF PROVIDED

NORTH OUTPARCEL FOUNDATION PLANTING

A: NOT REQUIRED
B: 60'x20'=1200 SFx12%=144 SF REQ'D; 288 SF PROVIDED
C: 50'x20'=1000 SFx12%=120 SF REQ'D; 123 SF PROVIDED
D: 60'x20'=1200 SFx12%=144 SF REQ'D; 343 SF PROVIDED

For each open utility cut of City streets, a \$325 permit shall be required from the City prior to occupancy and/or project acceptance.