



**DATE:** 11.21.2019  
**TO:** ProTrak  
**FROM:** Mitesh Baxi  
Traffic Engineering

910 341-3258  
910 341-7801 fax  
www.wilmingtonnc.gov  
Dial 711 TTY/Voice

■ **MAIDES PARK GYMNASIUM ADDITION [TRC Plan Review #3]**

**TECHNICAL STANDARDS – ACCESS (sight distance):**

1. The City's 20'x70' sight distance triangle is not implemented correctly at the northern driveway. Please revise as per below image. [Sec.18-529(c) (3) CofW LDC] [Sec. 18-812 CofW LDC].

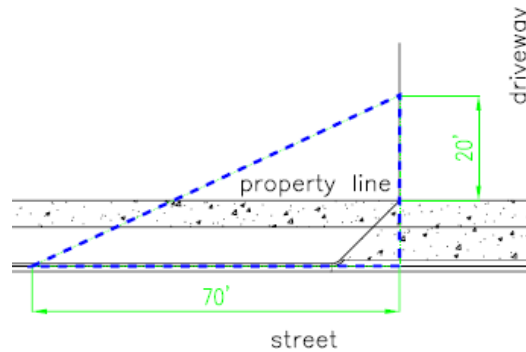

Please let me know if you have any questions or if I can be of further assistance as this development moves through the review process.