

DATE: 08.21.2018

TO: ProTrak

FROM: Mitesh Baxi
Traffic Engineering

910 341-3258
910 341-7801 fax
www.wilmingtonnc.gov
Dial 711 TTY/Voice

■ **PARKWAY VOLVO [TRC Plan Review #2]**

BASE INFORMATION:

- The site is within 500' of a signalized intersection. Revise all relevant sheets to accurately illustrate the existing conditions on and surrounding this parcel. Show all adjacent traffic signs, lane configurations, traffic control devices and pavement markings intersection Market St with N Cardinal Dr. Please refer to the Technical Standards and Specifications Manual (link is below) Ch. VII C.1.a.2. for specific information and distance requirements. Contact Traffic Engineering at 341-7888 if you need assistance locating these elements.
- The driveway is incorrectly labelled as 'N Cardinal Ext. Dr'. Please verify and revise.

TECHNICAL STANDARDS – ACCESS (driveway, sidewalk, and sight distance):

1. Driveways off Market St, are proposed to be discontinued. When the use of any driveway has been permanently discontinued, replace all necessary curbs, gutters, aprons, sidewalks, and appurtenances thereto. [\[Sec. 18-530 CofW LDC\]](#). Label it accordingly.
2. A public sidewalk connection with the site shall be ADA accessible. Please verify the grades and provide a curb ramp if required. Also provide an accessible route to the nearest entrance of the building. [\[ADA standards\]](#)
3. The City's 20'x70' sight distance triangle is not implemented correctly. Please revise. [\[Sec.18-529\(c\)\(3\)CofW LDC\]](#)

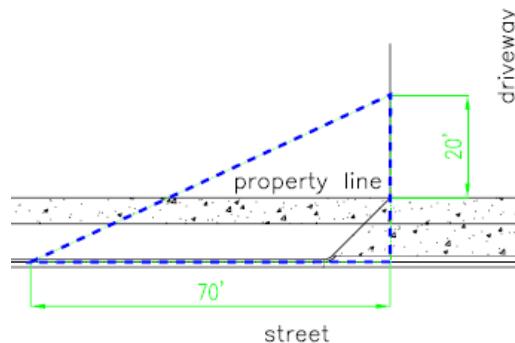

TECHNICAL STANDARDS – Barrier Free Design:

4. The handicap ramp connecting with accessible route shall be installed as per ADA standards. Please detail the tactile warning mat on the site plan. [\[City/ADA standards\]](#)

Please let me know if you have any questions or if I can be of further assistance as this development moves through the review process.