



DATE: 08.12.2019
TO: ProTrak
FROM: Mitesh Baxi
Traffic Engineering

910 341-3258
910 341-7801 fax
www.wilmingtonnc.gov
Dial 711 TTY/Voice

■ **MAIDES PARK GYMNASIUM ADDITION [TRC Plan Review #2]**

TECHNICAL STANDARDS – ACCESS (sight distance):

1. The City's 20'x70' sight distance triangle is not implemented correctly. Please revise as per below image. [Sec.18-529(c) (3) CofW LDC] [Sec. 18-812 CofW LDC].

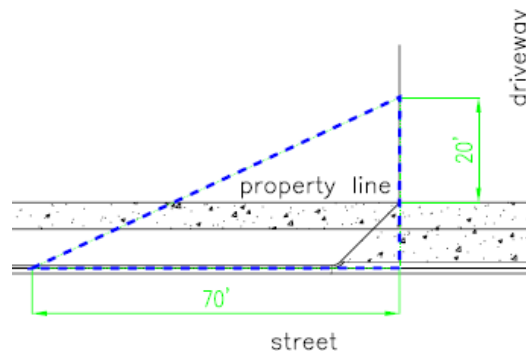

TECHNICAL STANDARDS – PARKING:

Recommendations:

This site does not fulfill the standard spacing requirements. Since the existing drive aisle width behind perpendicular parking is more than sufficient (minimum acceptable is 24') there is an opportunity for the developer to bring the parking space length into compliance while restriping the pavement markings for the facility.

- The minimum standard vehicle parking space size is 8.5' in width by 18' in length.
- The minimum vehicle parking space size must be 15.5' in length before wheel stop or curb functioning as a wheel stop. [Page 7-20 of CofWTSSM]

Please let me know if you have any questions or if I can be of further assistance as this development moves through the review process.