



**Planning, Development
and Transportation**

Transportation Planning
305 Chestnut Street
PO Box 1810
Wilmington, NC 28402-1810

910 341-3258
910 341-7801 fax
www.wilmingtonnc.gov
Dial 711 TTY/Voice

DATE: 07.01.2019
TO: ProTrak
FROM: Mitesh Baxi
Traffic Engineering

■ **ST MARK MAYFAIRE ENTRANCE [Plan Review]**

REVISED STANDARD STREET LIGHTING PLAN [[City of Wilmington Street Lighting Policy](#)]:

1. The standard streetlight shall be a DEP designated LED equivalent fixture installed within the recommended range of mounting heights for the specific fixture. The standard streetlight shall be installed on a wooden pole in areas served from overhead facilities and on a fiberglass pole in areas served from underground facilities.
2. A layout for the Standard street lighting has been provided with the review. Minimum of 2 LED 50 and 6 LED 105 street lights are required for this sub-division. Although, developers may choose to provide any extra lights or ornamental. Any installations above the criteria of Standard street lighting, will be considered as non-standard and has to conform to the City's non-standard street lighting procedure as per the policy.
3. If non-standard lighting is desired then we will need a photometric analysis to verify that light levels in the roundabout are maintained and the light spacing on the approaches would be ½ indicated on the plan.
4. Developers shall bear any installation costs associated with streetlights, if applicable. In areas served from underground facilities, the developers shall pay the one-time underground contribution charge, if applicable.
5. The Planning, Development and Transportation Director or designee and the City Landscape Designer will coordinate plaza plantings and streetlight locations to minimize the obstruction of light by vegetation.
6. Street trees must be located a minimum of 15 feet from street lights. [[CofW SD 15-17](#)]
7. All the street light shall be installed within the public ROW.

Please let me know if you have any questions or if I can be of further assistance.

IS AND MARKINGS OFF THE RIGHT OF WAY ARE TO BE MAINTAINED BY THE

GS AND LANE ARROWS WITHIN THE PARKING AREAS SHALL BE WHITE.

QUIRED FOR EACH OPEN CUT OF A CITY STREET. IN CERTAIN CASES, AN
HE AREA BEING OPEN CUT MAY BE REQUIRED.

CITY AND NCDOT STANDARDS.

ATING THE LOCATION OF REQUIRED STREET TREES SHALL BE SUBMITTED TO
RAFFIC ENGINEERING DIVISION AND RECREATION DEPARTMENT FOR REVIEW
HE RECORDING OF THE PLAT.

RING AT 341-7888 FORTY-EIGHT (48) HOURS PRIOR TO ANY EXCAVATION IN

NOT DESIGNATED TO BE DEMOLISHED SHALL BE MILLED 1-INCH TO ALLOW FOR

T APPROVE OF PAVEMENT MARKING LAYOUT PRIOR TO ACTUAL STRIPING.

ST MARK CATHOLIC CHURCH
ROMAN CATHOLIC DIOCESE RALEIGH
D.B. 967 PG. 640
ZONING: R-15
LAND USE: 866 - RELIGIOUS ACTIVITIES

MILDRED LACKEY
D.B. 1635-1000
ZONING: R-10
LAND USE: RESIDENTIAL

EASTWOOD VILLAGE
SECTION 9R
M.B. 31/289

ZONING: R-10
LAND USE: RESIDENTIAL

St Mark Mayfaire Entrance Standard Street Lighting Plan - Revised

1. Developers shall bear any installation costs associated with streetlights, if applicable. In areas served from underground facilities, the developers shall pay the one-time underground contribution charge, if applicable.
 2. Streetlights will be reviewed through the subdivision process and must meet criteria established in City's Street Lighting Policy.
 3. All street lights shall be installed within proposed public ROW.
 4. Street trees must be located a minimum of 15' from street lights [SD 15-17 of CofWTSSM].
- Suggested approximate locations of minimum required 2 LED 50.
 - Suggested approximate locations of minimum required 6 LED 105.
- Locations may vary as per the field survey by DEP.

07/01/2019

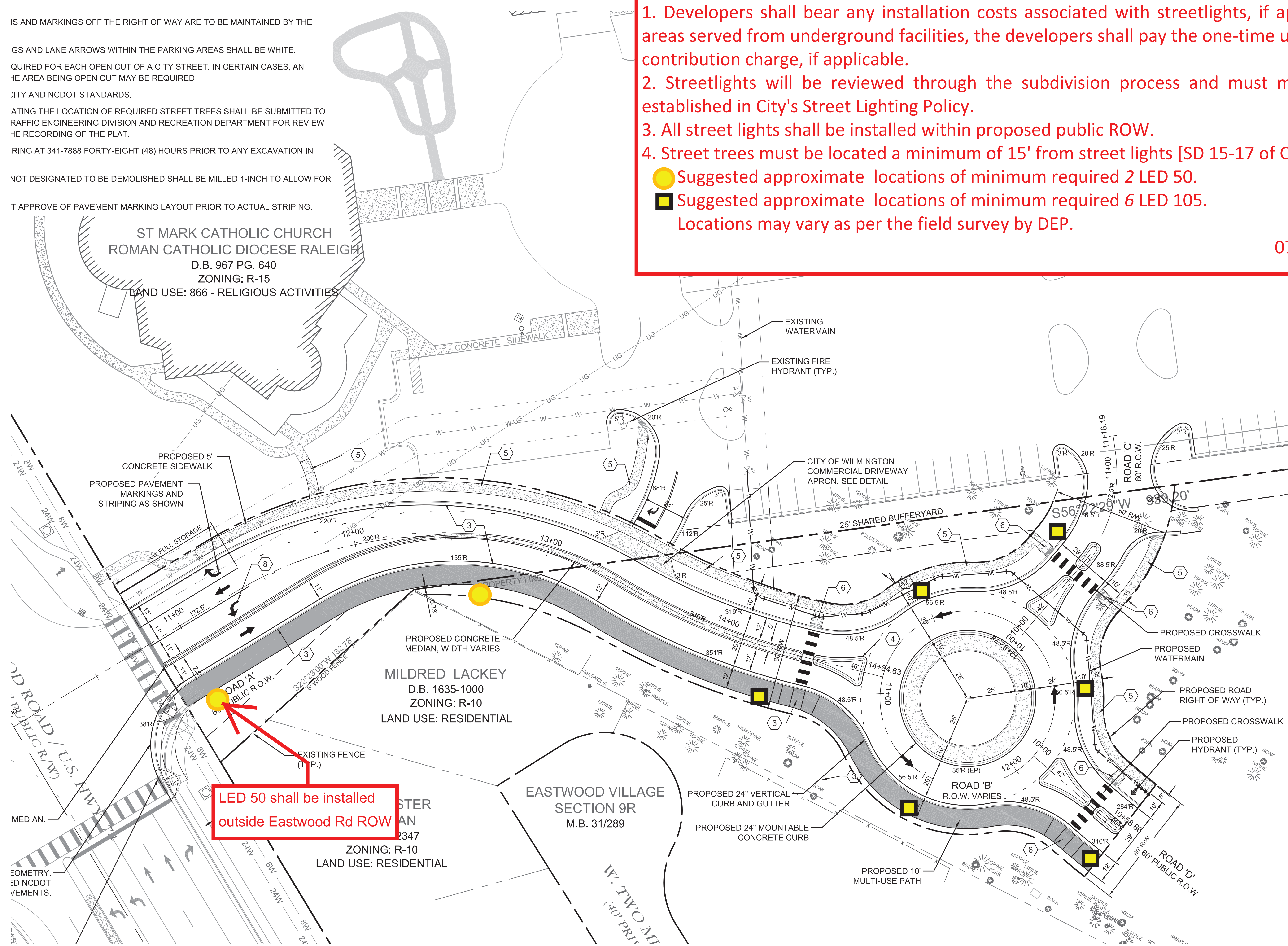

LED 50 shall be installed
outside Eastwood Rd ROW

MAYFAIRE II LLC
530 SE GREENVILLE BLVD, STE. 200

PARAMOUNT ENGINEERING, INC.

122 Cinema Drive
Wilmington, North Carolina 28403

IGN - NOT RELEASED FOR CONSTRUCTION

OVERALL SITE PLAN
ST. MARK CATHOLIC CHURCH &
MAYFAIRE II ENTRANCE
EASTWOOD ROAD

PROJECT STATUS
CONCEPT LAYOUT:
FINAL LAYOUT:
DESIGNED FOR CONSTRUCTION:
DRAWING INFORMATION
DATE: 08/07/18
SCALE: AS SHOWN